

DISCLAIMER:

- REFER TO DEO LOADING, PURGING, AND BYPASS GUIDELINES.
- LOCATIONS OF ALL PURGE OUT POINTS ARE APPROXIMATE.
- FIELD VERIFY ALL CUT POINTS.

GAS PLANNING - GAS FEED DISCLAIMER:

- GAS FEED INFORMATION PROVIDED WAS OBTAINED FROM GAS PLANNING AND REPRESENTS "TYPICAL FLOW" UNDER NORMAL OPERATING CONDITIONS.
- GAS FEED INFORMATION AS SHOWN AT TIE-IN LOCATIONS IS FOR REFERENCE ONLY AND MUST NOT BE USED IN DETERMINING THE NEED FOR BY-PASS PROCEDURES.
- GAS PLANNING MUST BE CONSULTED TO VERIFY FEED AT TIME OF CONSTRUCTION.

- EXISTING DIRECTION OF FLOW
- EXISTING GAS MAINLINE
- EXISTING GAS MAINLINE TO BE ABANDONED
- EXISTING GAS MAINLINE TO BE REMOVED
- CENTERLINE OF ROAD
- EXISTING MAINLINE END CAP

LEGEND
 PURGE OUT POINT (LP) APPROX. LOCATION

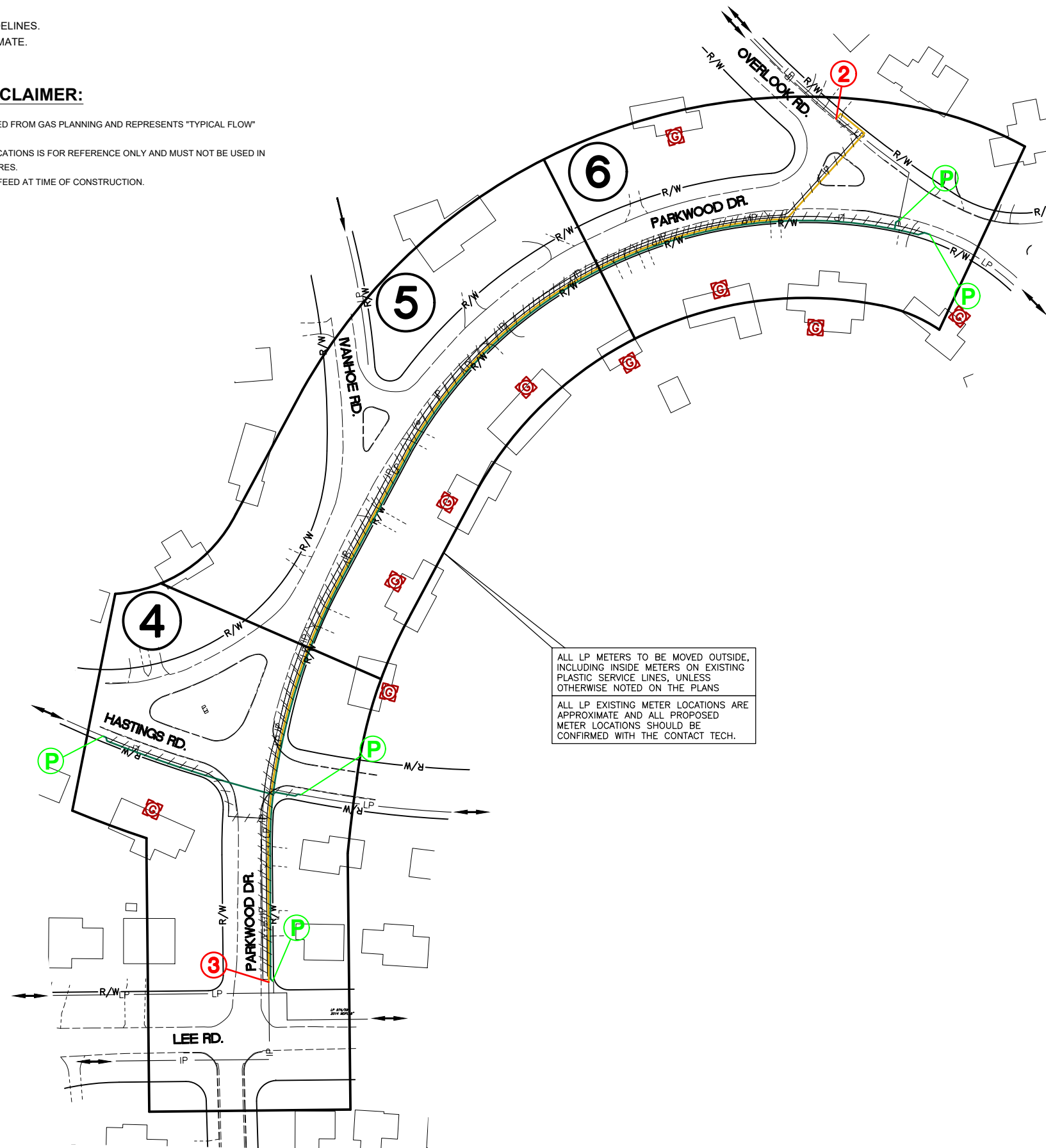

ALL LP METERS TO BE MOVED OUTSIDE, INCLUDING INSIDE METERS ON EXISTING PLASTIC SERVICE LINES, UNLESS OTHERWISE NOTED ON THE PLANS

ALL LP EXISTING METER LOCATIONS ARE APPROXIMATE AND ALL PROPOSED METER LOCATIONS SHOULD BE CONFIRMED WITH THE CONTACT TECH.

- INSTALL 12" HDPL IP MAIN.
- INSTALL 6" SPHERICAL TEE ON EXISTING 6" STEEL IP MAIN.
- SQUEEZE AND BY-PASS EXISTING 12" HDPL IP MAIN. INSTALL 12" EF CPLG ON EXISTING 12" HDPL MAIN.

THE OWNER DOES NOT WARRANT THE ACCURACY, SUFFICIENCY, OR COMPLETENESS OF THIS DRAWING OR MAP FOR ANY PURPOSE, AND RELIANCE HEREON AND USE HEREOF IS AT THE RISK OF THE USER, WHO AGREES TO HOLD HARMLESS AND INDEMNIFY THE OWNER AGAINST ANY AND ALL LIABILITY IN CONNECTION WITH ITS USE.



NORTH

REV	DESCRIPTION	DATE	BY



PARKWOOD DR - PIR 3675-C

PURGE POINTS / INDEX MAP

DATE: 11/29/2022
 PROJECT ID #: P401649064

3
8